

Isolation Thermal Break Medium Duty Veneer Wall Tie

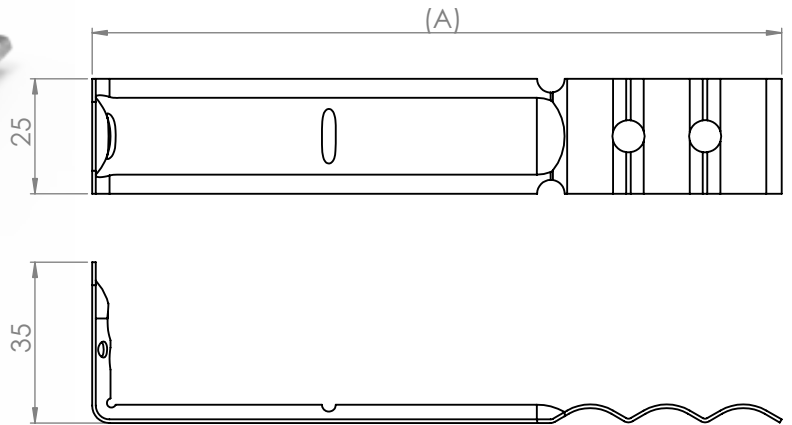

DESCRIPTION

Isolation and thermal break washer face fix medium duty veneer wall tie, Type A

FEATURES

- Isolated tie so you can benefit from using a Stainless tie with a Galvanised screw and frame
- Thermally broken to create an insulated barrier
- Quicker to deploy with included driver
- Screw fastener for a faster installation time, less frame loosening
- Greater fastener tensile load
- Clay brick / block work
- Multiple fixing application for different substrates
- Max cavity 125mm
- Universal applications
- Australian design & tested AS/NZS 2699.2:2020

SIZES

Standard Sizes : 125mm

Special Order : 100mm, 150mm, 175mm and 200mm

FIXING REQUIREMENTS

- S/Drilling hex head 10g X 25mm galvanised class 3 finished (Metal)
- Cerra Multipurpose Screw hex head 10g X 35mm (Metal / Timber)
- For more information contact us with your project requirements.

CORROSION CHARACTERISTICS

Stainless steel 316L (R4)

Conforms to corrosion resistance set by AS/NZS 2699.2:2020 / AS 3700.

ORDERING INFORMATION

When ordering please supply use with the part number and quantity you require

CGT12-ITB-125

PRODUCT CODE

LENGTH

A

100 **SPECIAL ORDER**

125

150 **SPECIAL ORDER**

175 **SPECIAL ORDER**

200 **SPECIAL ORDER**

